



Alexander Hudson Estates

Sales Particulars

Alexander Hudson Estates

Fulmar Drive, Backworth Park, NE27



The Property

Alexander Hudson are delighted to welcome to the market this superb four bedroom three storey semi-detached family home, enjoying an attractive position, situated in a quiet cul-de-sac location within the popular Backworth Park.

This beautifully presented property is tastefully styled throughout and comprises of an entrance hallway, downstairs WC, spacious living room and a bright and modern kitchen/ dining room with integrated appliances. On the first floor lies a generously sized family bathroom and three bedrooms. To the top floor you will find the primary of which benefits from a dressing area, mirrored fitted wardrobes and en-suite shower room. Externally, the rear of the property benefits from a lawned garden and patio area with a detached garage and driveway with space for two cars.

The property is ideally located with a good range of local amenities within Northumberland Park and Silverlink Retail Park and boasts excellent transport links, including Metro link, the A19 and A1, providing ease of access across Newcastle, the coast and Northumberland countryside. Popular schools, Backworth Park Primary School and Holystone Primary School are both within walking distance.

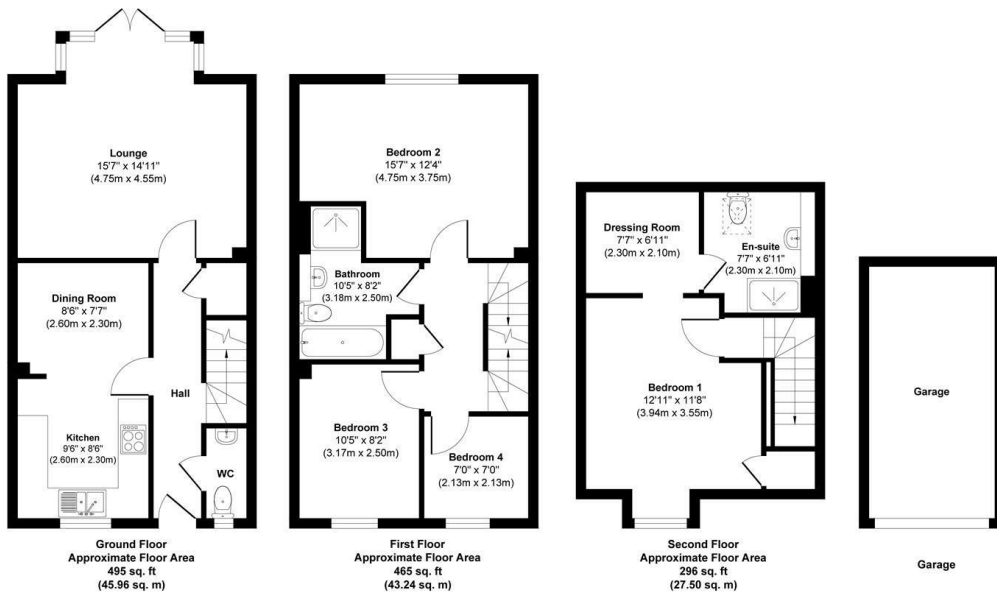

Approx. Gross Internal Floor Area 1256 sq. ft / 116.70 sq. m (Excluding Garage)

Illustration for identification purpose only, measurements approximate and not to scale, unauthorized reproduction is prohibited. All rights reserved for Alexander Hudson Estates

Freehold
Council Tax: D
EPC Rating: 84

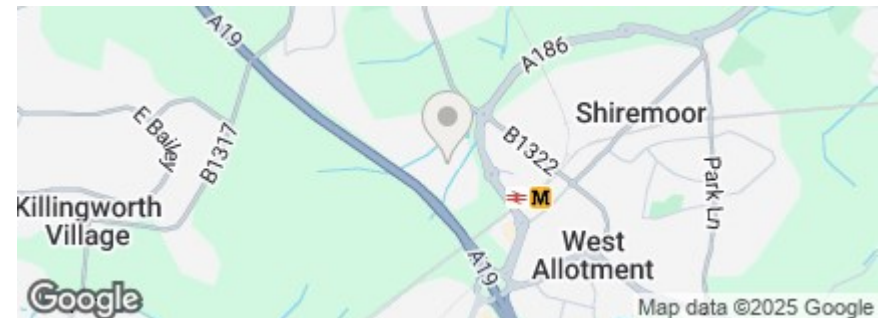



Alexander Hudson Estates
The Printworks
20 Arrow Close
NE12 6QN

0191 268 7433
sales@alexanderhudson.co.uk